

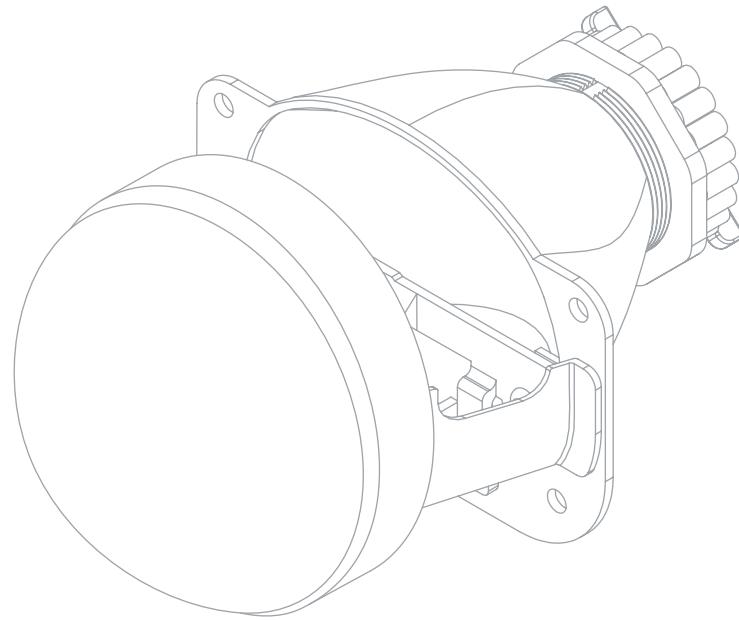

THE AUTOMOTIVE LIGHTING BENCHMARK



INSTALLATION GUIDE

CYCLE STAGE 1 KIT



WARNING: By reading this document, I agree it is only to be used as an educational guide. Morimoto Lighting makes no guarantee on any finished results, nor are they to be held responsible for any damage, misuse, or personal injuries. Use at your own risk. If you are unable to clearly understand and adapt the information below to your own application, professional installation is recommended.

TABLE OF CONTENTS

SYSTEM DIAGRAM	P.3
HARNESS INSTALLATION	P.4
PROJECTOR INSTALLATION	P.4
HARDWARE CONTENTS	P.4
HARDWARE SCHEMATIC	P.4
BULB INSTALLATION	P.5
BALLAST INSTALLATION	P.5
HALO INSTALLATION	P.6
SHROUD INSTALLATION	P.7
USING RETRORUBBER SEALANT	P.7

STANDARD PARTS



1X TEST LEAD



1X D2S HID BULB



1X D2S IGNITERS

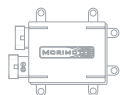

1X BALLAST COMPUTER

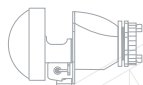

1X MINI D2S 3.0
PROJECTOR



1X H4 CYCLE-SPECIFIC
HARNESS

OPTIONAL PARTS



1X PROJECTOR SHROUD



1X XSB 2.0 LED HALO



1X RETRORUBBER SEALANT

SPECIAL NOTE:

The included ballast test lead is used for troubleshooting purposes only and is not part of the installation of this system. If necessary, the test lead can be plugged into the ballast input then connected to a 12V+ source to test the ballast. This must be done with the bulb connected to the ballast prior to applying power.



Ballast Test Lead



NOTE: System diagrams are to be used for reference purposes only. If you are unsure of the installation procedure for any individual part, review its install procedure prior to proceeding.

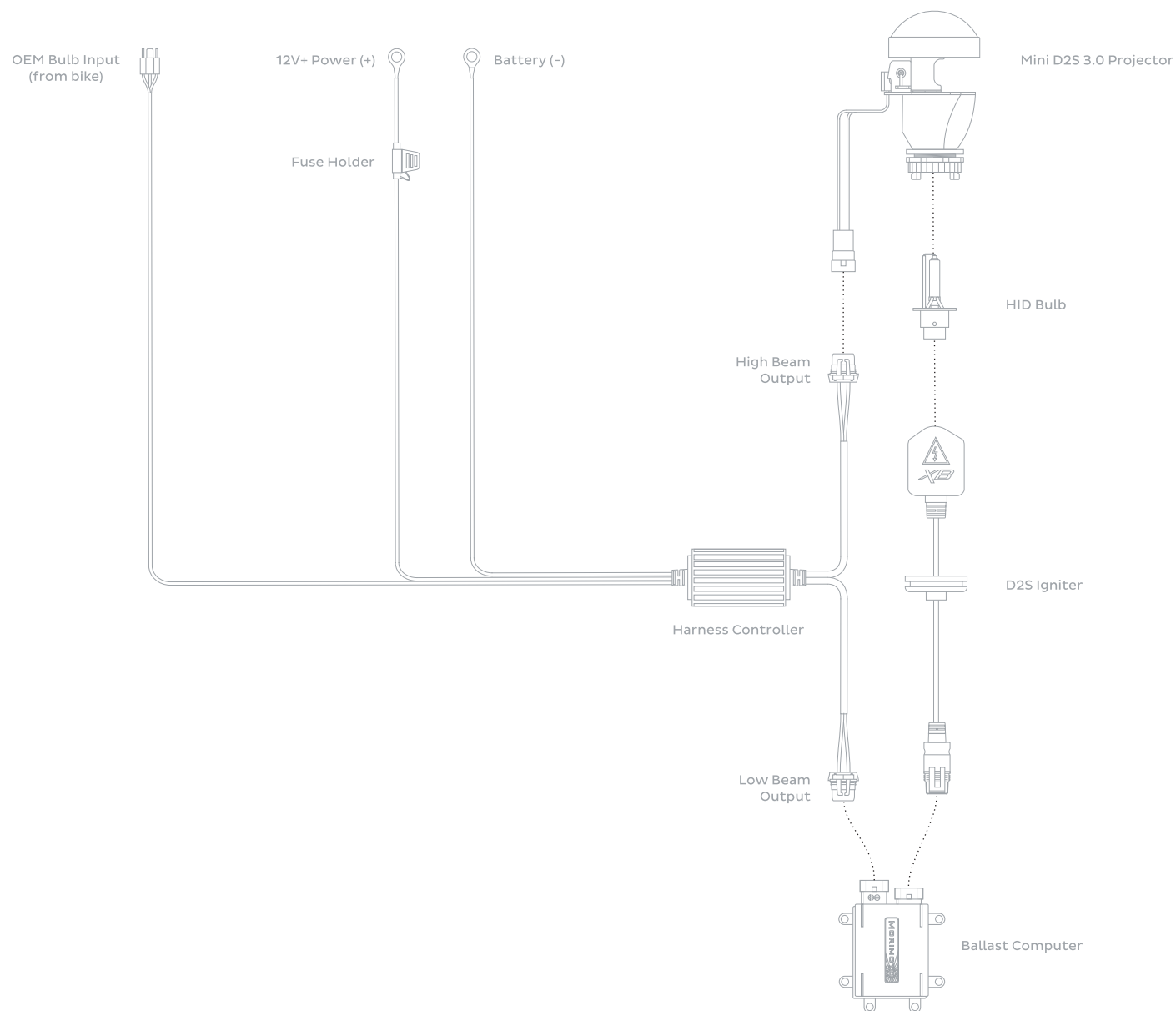

HARNESS INSTALLATION

SPECIAL NOTE

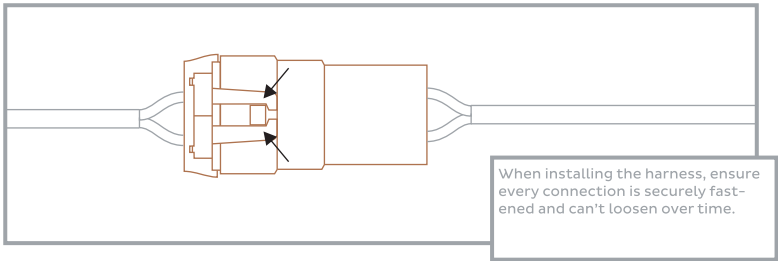

PROJECTOR INSTALLATION

SPECIAL INSTALLATION NOTE

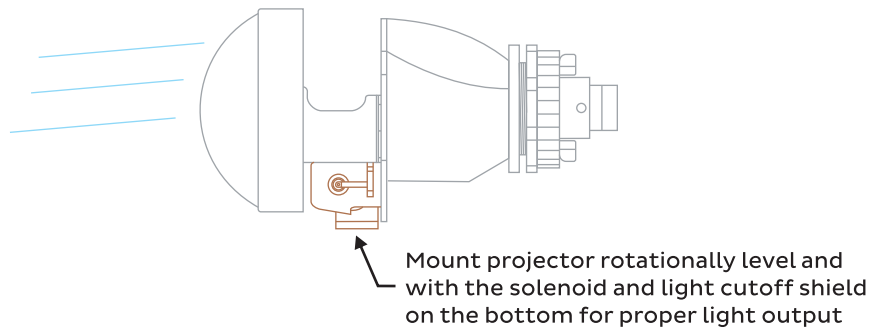

HARDWARE SCHEMATIC

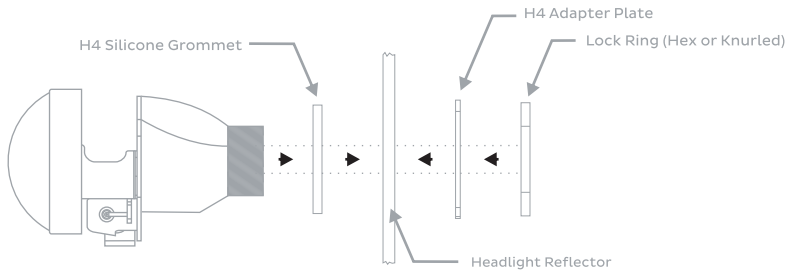

HARDWARE CONTENTS



1X H4 Silicone Grommet



1X H4 Adapter Plate



1X Hex Lock Ring



1X Knurled Lock Ring



1X Bulb Retaining Cap



1X Bulb Retaining Spring



1X 9006 Male Connector



2X 9006 Socket Grommets

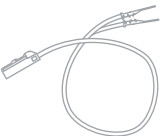

1X Solenoid Pigtail

SOLENOID WIRING SCHEMATIC

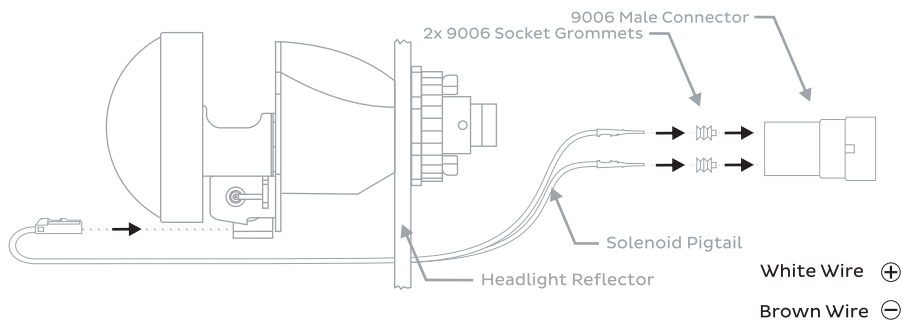

BULB INSTALLATION



CAUTION: HOT!



HANDLE ONLY WITH
BLACK PLASTIC BASE

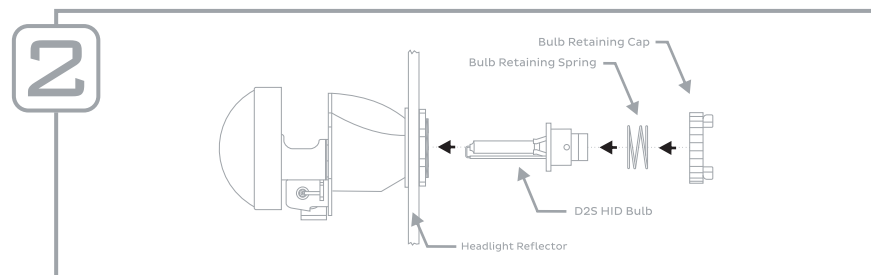
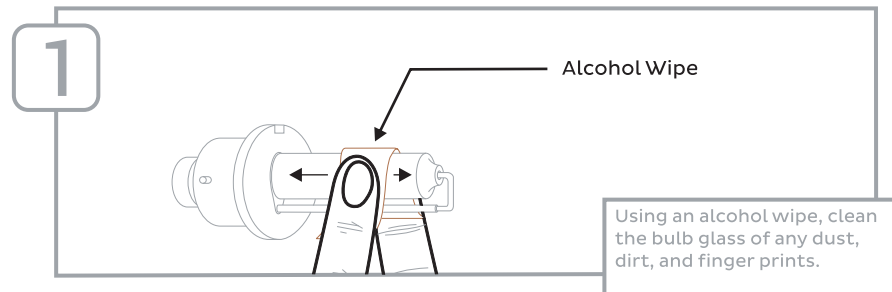

BALLAST INSTALLATION



DO NOT IGNITE UNTIL
FULLY CONNECTED!



WATERPROOF

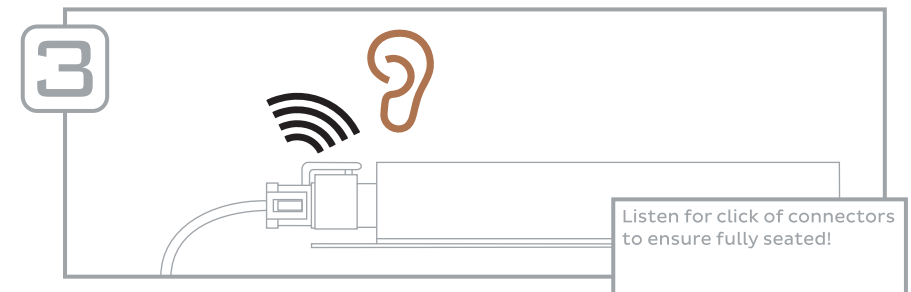
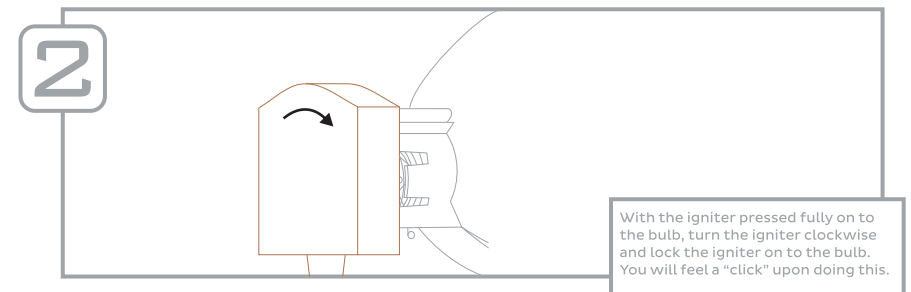
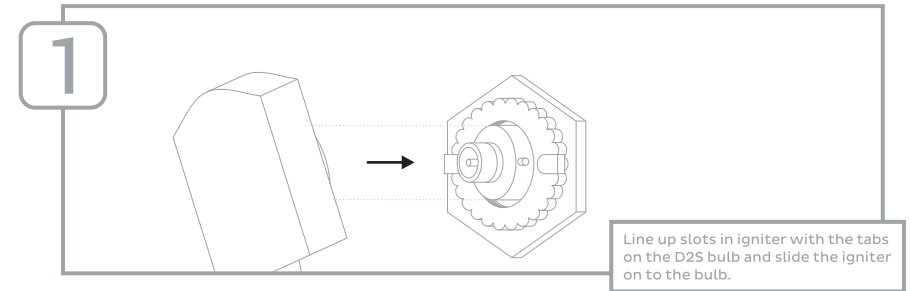

4

Recommended mounting:

Do not mount ballast with connectors aimed upward!

XSB HALO INSTALLATION

12V

12VDC INPUT



DO NOT CUT!



DO NOT GLUE!

1

Using a small flathead screw driver or paper clip, press the tabs holding the halo pins into the connector and remove the wiring from the connector.

2

Test-fit the halo on the shroud to see where it will be mounted.

3

Using a 1mm drill bit, make one hole for each mounting tab, then another hole slightly outside of that for wire to feed up and over the mounting hole.

4

In the desired location, drill a 4mm hole for the wiring to pass through the shroud/bezel.

5

Feed the wiring through the 5mm hole in the shroud / bezel and re-insert the pins into the connector, ensuring proper orientation of the wire colors.

6

Using thin wire or fishing line, loop a piece up and through the halo mounting tab then secure from behind the shroud / bezel. Epoxy is recommended for the wire / fishing line.

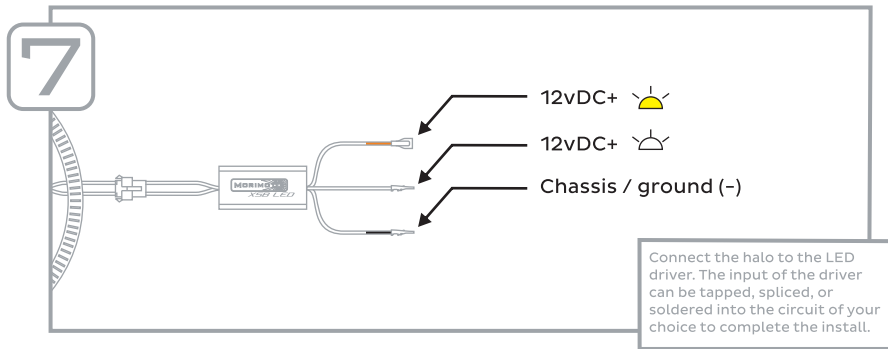

SHROUD INSTALLATION



EPOXY IS RECOMMENDED
FOR ALL CONTACT POINTS



E-Z CUT

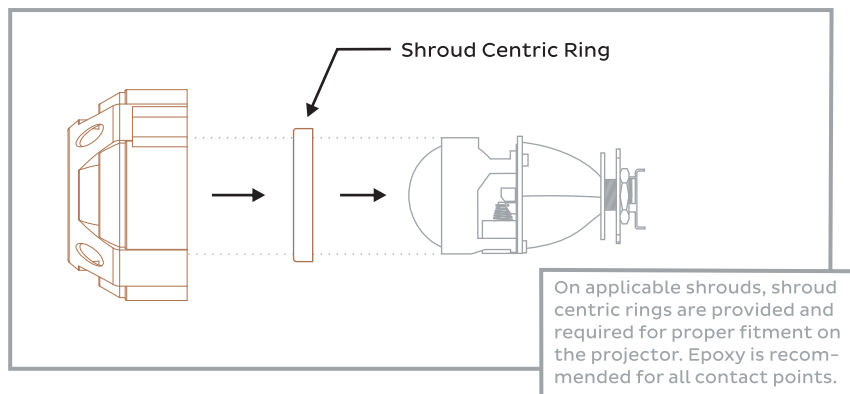

USING RETRORUBBER SEALANT

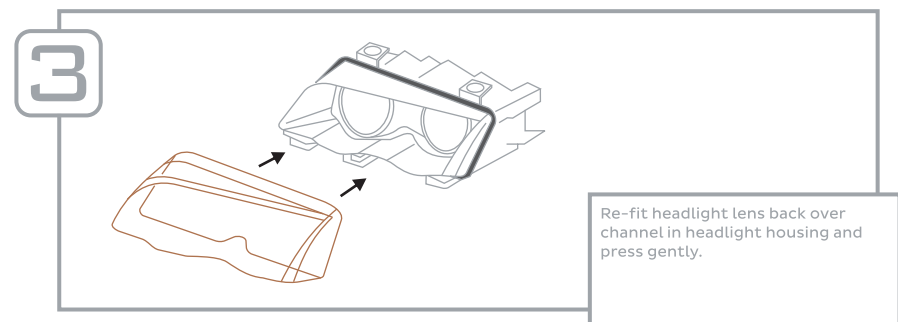
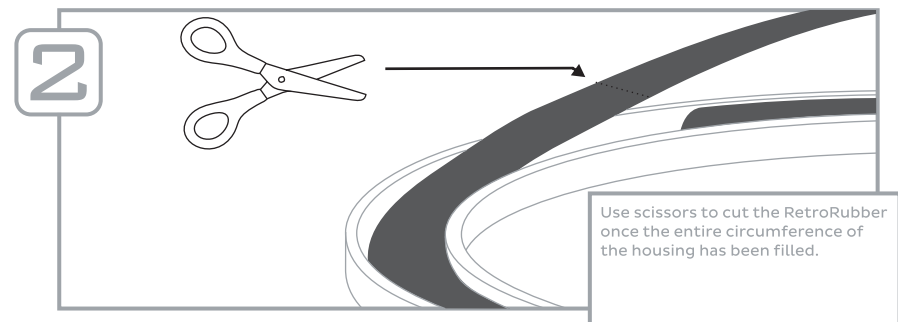
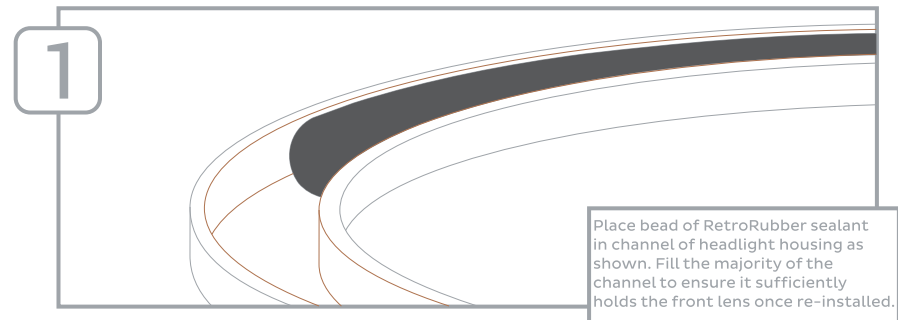

4

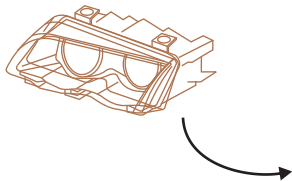

Place entire headlight in oven for seven (7) minutes at 270 Fahrenheit / 130 Celsius to soften the new sealant.

5

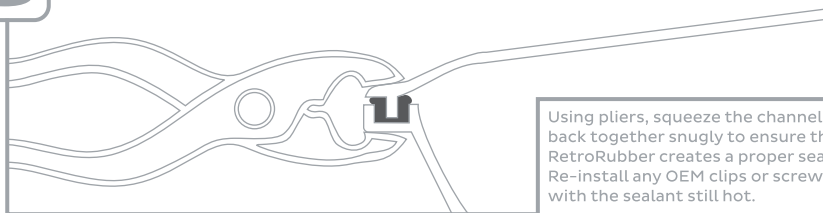

Using pliers, squeeze the channel back together snugly to ensure the RetroRubber creates a proper seal. Re-install any OEM clips or screws with the sealant still hot.

6

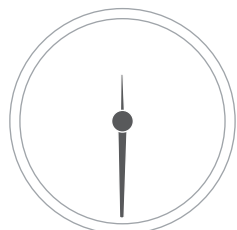

00:30:00

Allow thirty (30) minutes for headlight to sufficiently cool down prior to re-installation on car.

-END-